

## Year 3: Mechanical / Energy Systems Engineering

### ASSIGNMENT 3

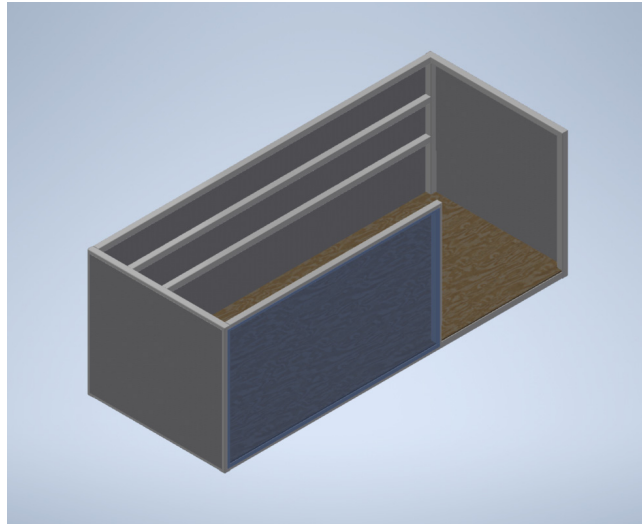

#### Instructions:

Having created the Frame based on the details given in tutorial 5 you are required to create a drawing of the frame using the template you created in year 2.

- Attach the 3 Mild steel plates provided on the Q drive to the frame as shown in the drawing below and weld the plates to the frame.  
2 OFF: 1050 x 1150 x 3mm THK  
1 OFF: 1050 x 2950 x 3mm THK
- Attach the wooden Floor provided on the Q drive as shown in the drawing..
- Attach the Perspex front Panel provided on the Q drive as shown in the drawing.

Create a drawing to specify the Frame and attached plates. Show the appropriate weld symbols on the drawing. Create as a A3 Drawings at an appropriate scale and to ISO standards.

Save the drawing as Assignment 3A dwfx file for handing in.

Refer to Frame Assignment dwfx file for placement of Panels and floor.

# ASSIGNMENT 3A

